

# LEAKMASTER

SINGLE COMPONENT WATER-SWELLING SEALANT

## LEAKMASTER

LEAKMASTER LV-1 is a single component water-swelling sealant with excellent and unique properties.

Its development was based on C.I. Kasei's technology and long experience in water-swelling sealants.

LEAKMASTER may be applied in locations where conventional solid sealants cannot be easily applied. This includes irregular shaped joints, rough surfaces, odd penetrations, etc.

After curing, LEAKMASTER has excellent physical properties. The rubber-like elasticity of the material and expansion characteristics create an effective watertight seal.

## ADVANTAGES

**EASY APPLICATION** – As a moisture-cure single component water-swelling sealant, standard caulking guns can be used.

**PHYSICAL PROPERTIES** – After curing, LEAKMASTER has better physical properties than those of conventional sealants.

**EXPANSION** – LEAKMASTER expands approximately two times its original volume when exposed to water. It provides excellent water sealing properties while retaining its rubberlike elasticity.

**ADHESION** – Before swelling, LEAKMASTER adheres to various materials such as concrete, metal, glass, etc.

## MAIN APPLICATION

- Water sealing at joints of in-situ cast concrete
- Water sealing around H-section steel joints and bars
- Caulking for water distribution systems
- Pipe penetrations
- Irregular joint surfaces
- Waterproofing work

**WARRANTY:** These specifications are to be used only as a general guideline by engineers in formulating preliminary specifications, and should not be relied upon without site-specific product testing; Greenstreak assumes no responsibility for the improper reliance upon or misuse of such data. In addition, product design and specifications are subject to change without notice.

All statements regarding this product are based upon procedures and tests which the manufacturer believes are reliable, and may be changed for improvement of quality without notice; but it will be the sole responsibility of the customer and/or end user to use this product properly, and therefore assume all risk and liability in connection herewith.



## CHARACTERISTICS

### 1. GENERAL PROPERTIES

Appearance	Putty-Like
Color	Grey
Specific Gravity	1.30
Extrudability	Within 20 seconds (at 23°C)
Slump	3mm max. (at 23°C)
Tack-Free Time	Within 8 hours (at 23°C, 60% R.H.)
JIS-A-5758	

### 2. PROPERTIES AFTER HARDENING

Hardness	35 Shore A
Tensile Strength	30 kgf/cm <sup>2</sup> (425 psi)
Elongation	1250%
Tear Strength	10 kgf/cm (56 lb/in)
JIS-K-6301	

### 3. SWELLING PROPERTIES

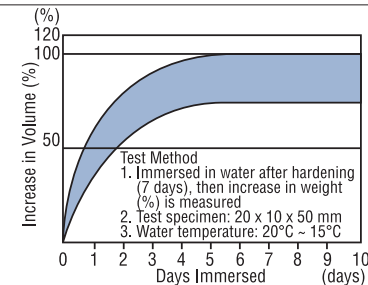

### 4. ADHESION PROPERTIES

	Steel	Aluminum	Mortar
50% Modulus (kgf/cm <sup>2</sup> )	4.5 64 psi	6.5 92 psi	6.5 92 psi
Max. Tensile Strength (kgf/cm <sup>2</sup> )	7.0 99 psi	12.2 173 psi	11.1 157 psi
Elongation at Break (%)	330	580	570
JIS-A-5758			

## APPLICATION

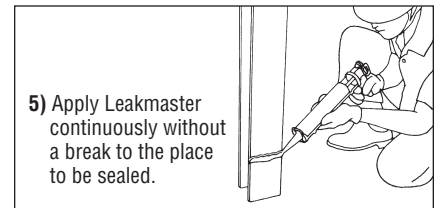
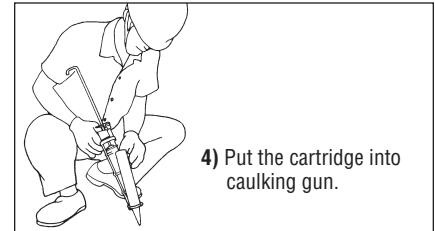
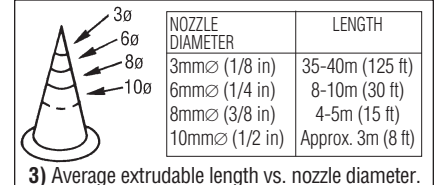
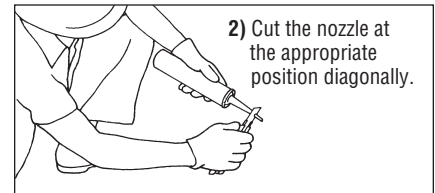
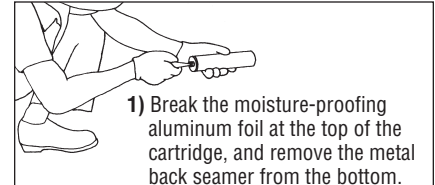

## PACKAGING

Item No.	LEAKMASTER LV-1
Cartridge	320 cc
Carton	24 cartridges



**GREENSTREAK GROUP, INC**  
 A Family of Construction Companies

3400 Tree Court Industrial Blvd., St. Louis, Missouri 63122  
 Phone: 800. 325-9504 or 636. 225-9400  
 Fax: 800. 551-5145 or 636. 225-9854  
[www.greenstreak.com](http://www.greenstreak.com)



Printed in U.S.A.  
 03/08